

# COMROD AT100D/S

## 10 m Marine Transmitting Antenna

### Application:

AT100D/S is a high quality glassfibre transmitting antenna with side feed for marine coastal and HF telephony bands. It matches well all modern SSB marine telephony transmitters.

### Electrical specifications:

|                   |                             |
|-------------------|-----------------------------|
| Frequency range   | 1.6-30 MHz                  |
| Power rating      | 1.5 kW PEP                  |
| Impedance         | See diagram on reverse side |
| Pattern           | Omnidirectional             |
| Polarization      | Vertical                    |
| Electrical length | 10 m (33 ft)                |

### Mechanical specifications:

|                             |   |
|-----------------------------|---|
| Design                      | Selfsupporting fiberglass rod with bronze flange.           |
| Height                      | 10 m (33 ft)  |
| Weight                      | 18.9 kg   |
| Sections                    | Base section: ATB50D/S 16.3 kg<br>Top section: APB50 2.6 kg |
| Wind rating                 | 55 m/s = 125 mph  |
| Moment of flexure           | 275 kpm at 55 m/s   |
| Deflection due to wind load | 5 m (16.7 ft) at tip ball at 55 m/s wind load               |
| Finish                      | Polyurethane lacquer, white                                 |
| Temperature range           | -55 °C, +55 °C; -67 °F, +131 °F                             |
| Optional                    | End feed  |

### Mounting:

The AT100D/S is well suited for mounting on a pedestal or flange. We recommend the AG21 or AG26 lead through insulator, if the tuner is placed indoor.

The flange holes are matched to M12 bolts.

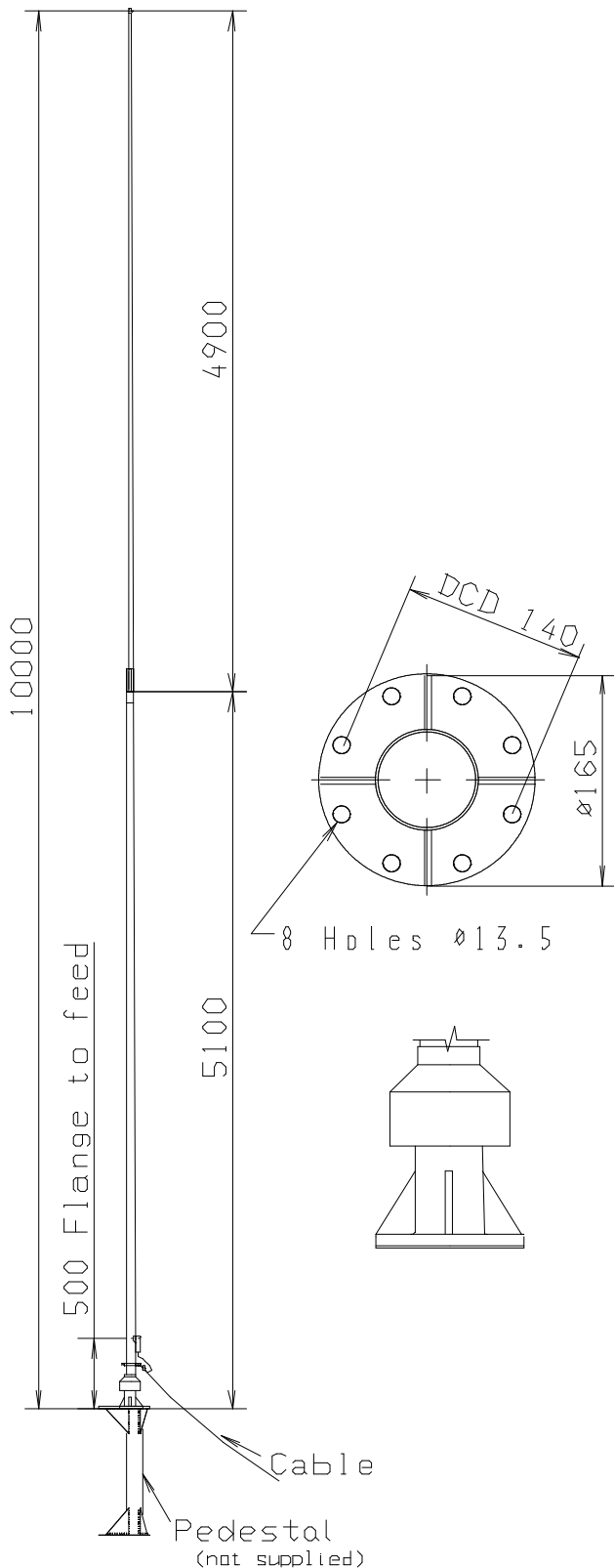

# Impedance at CF and HF

Frequency in MHz, normal installation

| Frequency (MHz) | Impedance AT100D/S |
|-----------------|--------------------|
| 1.6             | 5-j1000            |
| 2.0             | 6-j600             |
| 3.0             | 10-j350            |
| 4.0             | 11-j200            |
| 6.0             | 24-j34             |
| 7.0             | 48+j57             |
| 8.0             | 80+j140            |
| 9.0             | 180+j275           |
| 11.0            | 750+j60            |
| 12.0            | 500-j350           |
| 13.0            | 250-j360           |
| 14.0            | 150-j300           |
| 16.0            | 70-j180            |
| 17.0            | 55-j135            |
| 22.0            | 200+j130           |
| 23.0            | 350+j60            |
| 25.0            | 275-j200           |
| 30.0            | 68-j52.5           |

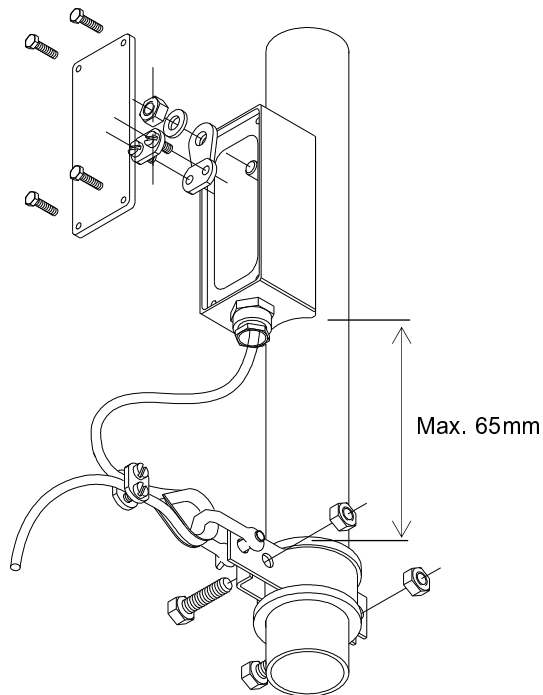

Installation of cable