

COMROD SHF4450P08

Band 4 Radio Relay Antenna , Ø0.75m

Application:

- ... Band 4, 4.4 –5.0 GHz
- ... Designed for point to point radio relay communication.
- ... Easy shifting of polarization.
- ... Rugged high quality antenna with a durable construction.
- ... Suited for harsh environments.
- ... For mounting in masts
- ... Removable feed for easy transportation

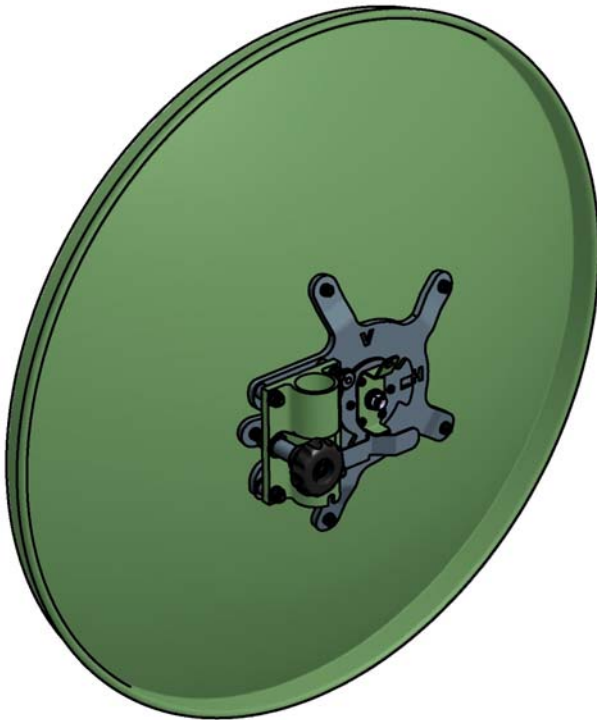
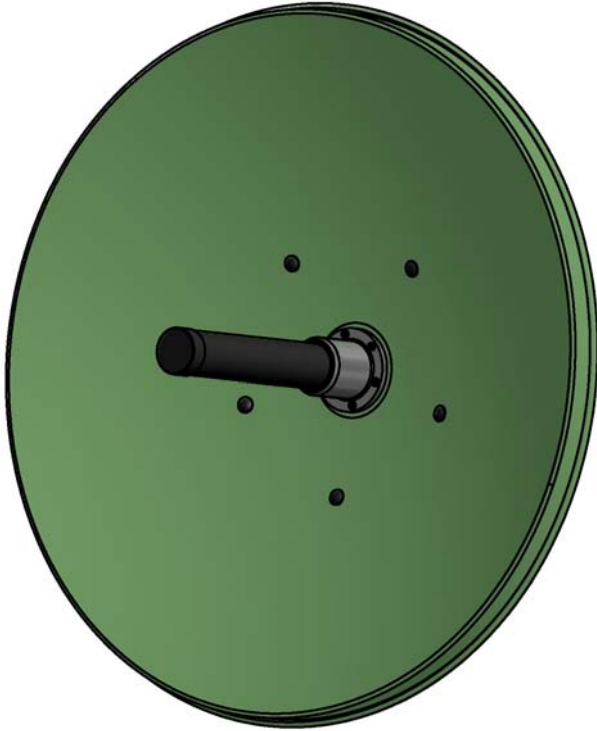

Electrical specifications:

Frequency range	4.4-5.0 GHz
VSWR	≤ 1.5
Connector	N - female 50Ω or customer specified
Power rating	20 W
Gain	> 27dBi
Beamwidth	5° @ ± 3dB
Polarisation	Vertical or Horizontal
Front to back ratio	> 30dB
Cross Pol. rejection	> 20dB

Mechanical specifications:

Design	Primary feed parabolic dish antenna. Dish and fixing made in aluminium and feed in fibreglass laminate.
Diameter	Ø 0.77m
Weight	5.2kg
Wind load	1000N @ 45m/s
Finish	Polyurethane lacquer
Temperature range	-55 °C, +71°C; -67 °F, +160 °F
Mast interface	Mast with Ø 39.5mm male spigot, or other solutions on request.

Radiation pattern

Date: 19-Aug-09
 Time: 12:30
 Operator: PE
 Ser. no.:
 Channel: Test
 Frequency: See Legend

Tx pol: Horiz. Rx pol: None
 Elevation : 0.00 Deg Lower Azimut: -45.01 Deg

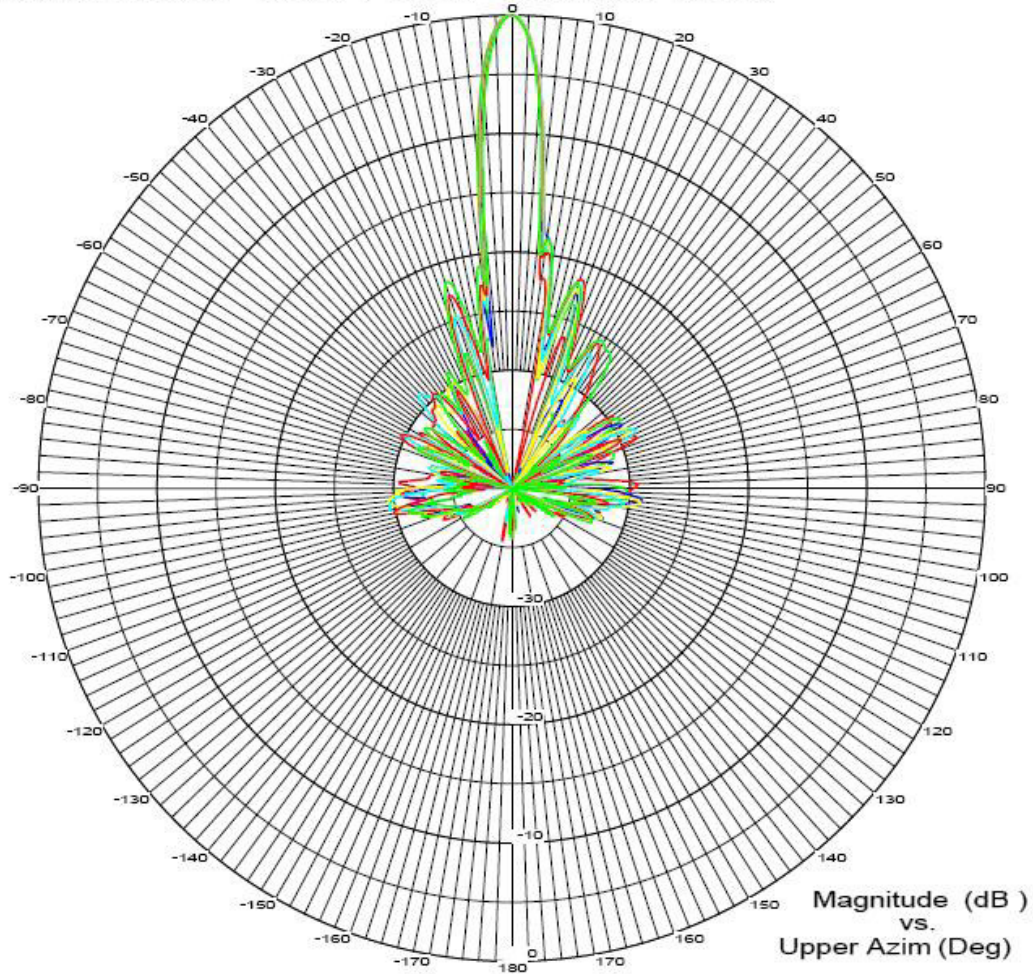

- Overlays
- Frequency : 4.400 GHz
 - Frequency : 4.500 GHz
 - Frequency : 4.600 GHz
 - Frequency : 4.700 GHz
 - Frequency : 4.800 GHz
 - Frequency : 4.900 GHz
 - Frequency : 5.000 GHz

FR959 Plus

